

PEAR SHAPE QUICK LINK, STEEL ZINC PLATED.

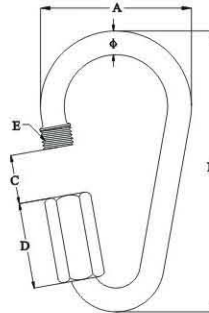

Part No.	φ mm	A mm	B mm	C mm	D mm	E mm	SWL kgs	BL kgs
41649	3.50	27.50	53.00	10.00	16.00	M5*0.9	56	280
41650	4.00	32.00	61.00	11.50	19.00	M6*1.0	80	400
41651	5.00	37.00	70.50	13.00	22.00	M7*1.0	120	600
41652	6.00	42.50	82.00	14.50	25.00	M9*1.25	200	1000
40954	7.00	48.00	90.50	16.00	28.00	M10*1.25	320	1600
41653	8.00	53.00	100.00	17.50	31.50	M11*1.25	480	2400
41654	9.00	58.00	108.00	19.00	33.00	M12*1.25	600	3000
41655	10.00	63.50	118.00	20.50	36.00	M13*1.25	720	3600
41656	12.00	76.00	144.00	23.50	43.00	M15*1.5	880	4400
41657	14.00	84.98	157.57	26.50	49.00	M17*1.5	1440	7200
41658	16.00	95.52	176.49	29.50	54.00	M19*1.5	2000	10000

SQUARE SHAPE QUICK LINK, STEEL ZINC PLATED.

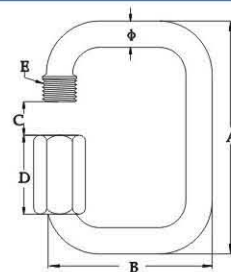

Part No.	φ mm	A mm	B mm	C mm	D mm	E mm	SWL kgs	BL kgs
41659	3.50	34.50	29.00	5.00	12.00	M5*0.9	70	350
41660	4.00	39.50	33.00	5.50	14.00	M6*1.0	100	500
41661	5.00	47.50	38.00	6.50	17.00	M7*1.0	150	750
41662	6.00	55.00	43.00	7.50	20.00	M9*1.25	250	1250
41533	7.00	63.50	48.00	8.50	22.50	M10*1.25	400	2000
41663	8.00	71.00	53.00	10.00	24.00	M11*1.25	550	2700
41664	9.00	78.00	58.00	11.00	27.00	M12*1.25	700	3500
41665	10.00	88.50	63.00	12.00	30.00	M13*1.25	900	4500
41666	12.00	102.00	74.00	15.00	34.00	M15*1.5	1100	5500
41667	14.00	117.00	85.00	17.00	38.50	M17*1.5	1800	9000
41668	16.00	135.00	96.00	19.00	45.00	M19*1.5	2000	11000
41669	18.00	153.00	107.00	23.00	59.00	M22*1.5	2600	13000

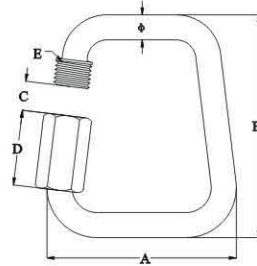
QUICK LINK TRAPEZOID SHAPE, STEEL ZINC PLATED & NICKEL.

Part No.	φ mm	A mm	B mm	C mm	D mm	E mm	SWL kgs	BL kgs
41677	9.00	68.00	80.00	11.00	27.00	M12*1.25	550	2750

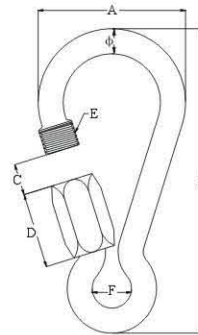
CALABASH SHAPE QUICK LINK, STEEL ZINC PLATED.

Part No.	φ mm	A mm	B mm	C mm	D mm	E mm	F mm	SWL kgs	BL kgs
41670	3.50	23.00	51.00	5.00	11.00	M5*0.9	6.00	56	280
41671	4.00	28.00	59.00	5.50	12.50	M6*1.0	7.00	80	400
41672	5.00	33.00	68.00	6.50	16.00	M7*1.0	8.00	120	600
41673	6.00	39.00	80.00	7.50	19.00	M9*1.25	9.50	200	1000
41674	7.00	43.00	89.00	8.50	21.50	M10*1.25	10.80	320	1600
41675	8.00	47.00	97.00	10.00	24.00	M11*1.25	12.50	480	2400

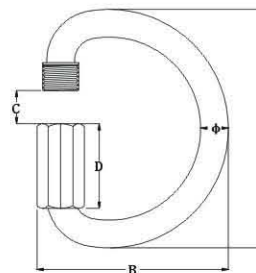
D-SHAPE QUICK LINK, STEEL ZINC PLATED.

Part No.	φ mm	A mm	B mm	C mm	D mm
41676	10.00	86.00	69.00	12.00	30.50

ANCHOR SHACKLE, STEEL ZINC PLATED.

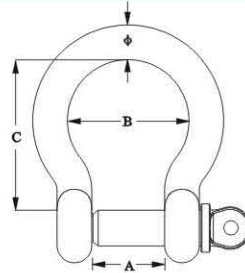

Part No.	ϕ mm	A mm	B mm	C mm
41682	6.00	12.00	21.00	27.00
41683	8.00	16.00	28.00	37.00
41684	10.00	20.00	35.00	46.00
41685	12.00	24.00	42.00	55.00

D-SHACKLE, STEEL ZINC PLATED.

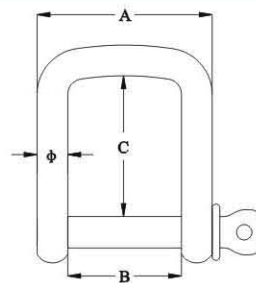

Part No.	ϕ mm	A mm	B mm	C mm
41686	6.00	34.50	22.50	30.50

D-SHACKLE, STEEL ZINC PLATED.

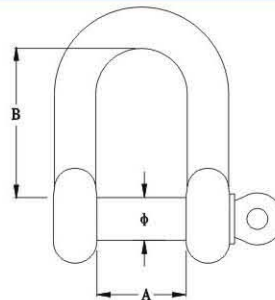

Part No.	ϕ mm	A mm	B mm
41678	6	13.00	21.00
41679	8	17.50	28.00
41680	10	20.00	35.00
41681	12	25.00	42.00

Part No.	ϕ mm	A mm
41687	3.00	15.00
41688	3.00	20.00
41689	3.00	25.00
41690	3.00	30.00
41691	3.00	35.00
41692	3.00	40.00
41693	4.00	20.00
41694	4.00	25.00
41695	4.00	30.00
41696	4.00	35.00
41697	4.00	40.00
41698	5.00	20.00
41699	5.00	25.00
41700	5.00	30.00
41701	5.00	35.00
41702	5.00	40.00
41703	5.00	45.00
41704	5.00	50.00
41705	5.00	60.00
41706	5.00	65.00
41707	6.00	25.00
41708	6.00	30.00
41709	6.00	35.00
41710	6.00	40.00
41711	6.00	45.00
41712	6.00	50.00
41713	6.00	55.00
41714	6.00	60.00
41715	6.00	80.00
41716	6.00	90.00
41717	7.00	40.00
41718	7.00	45.00
41719	7.00	50.00
41720	7.00	55.00
41721	7.00	60.00
41722	7.00	65.00
41723	8.00	30.00
41724	8.00	35.00
41725	8.00	40.00
41726	8.00	45.00
41727	8.00	50.00
41728	8.00	55.00
41729	8.00	60.00
41730	8.00	65.00
41731	8.00	70.00
41732	8.00	75.00
41733	8.00	80.00

ROUND RING WELDED, STEEL ZINC PLATED.

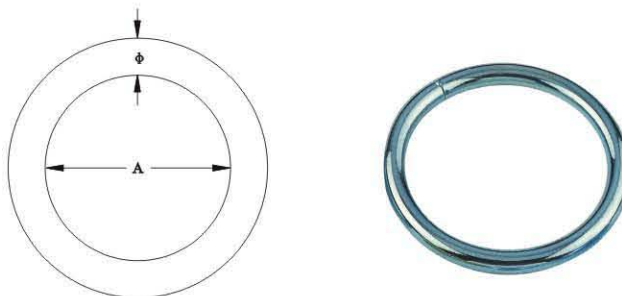

DEE RING WELDED, STEEL ZINC PLATED.

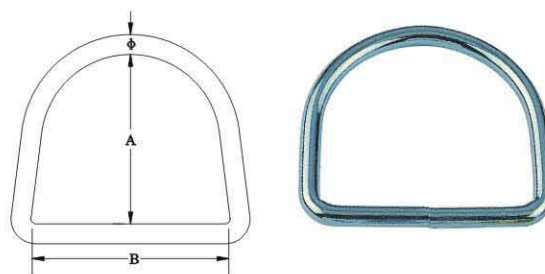

Part No.	ϕ mm	A mm	B mm
41734	3.00	22.00	26.00
41735	4.00	22.00	27.00
41736	4.00	25.00	30.00
41737	5.00	22.00	26.00
41738	5.00	25.00	30.00
41739	5.00	30.00	35.00
41740	5.00	35.00	40.00
41741	6.00	30.00	35.00
41742	8.00	43.00	51.00
41743	8.00	60.00	70.00
41744	8.00	68.00	80.00

S-HOOK, STEEL ZINC PLATED.

Part No.	ϕ mm	A mm	B mm	R mm
41759	3.00	25.00	3.50	3.50
41760	4.00	35.00	5.00	5.50
41761	5.00	45.00	6.00	7.00
41762	6.00	55.00	7.00	8.00
41763	7.00	65.00	8.00	10.00
41764	8.00	75.00	8.50	11.50
41765	9.00	90.00	11.00	12.00
41766	10.00	103.00	13.00	12.50

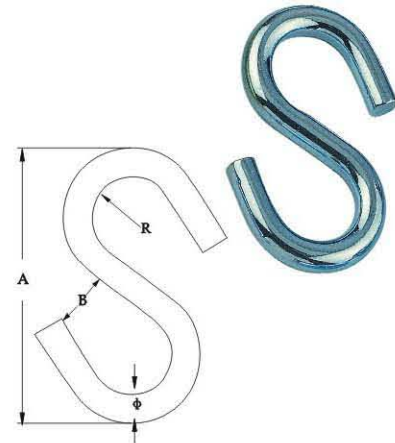

THIMBLE (LIGHT TYPE, STAMPED), STEEL ZINC PLATED.

Part No.	A mm	B mm	C mm	D mm	E mm
41745	7.50	18.00	20.60	4.50	3.00
41746	9.00	21.00	25.00	6.40	4.00
41747	10.50	24.00	27.00	7.00	5.00
41748	13.00	26.00	30.50	8.00	6.00
41749	14.50	32.00	37.00	10.00	7.00
41750	20.00	43.00	48.50	13.00	9.00
41751	25.50	49.00	56.00	14.00	11.00
41752	28.00	61.00	70.50	16.00	12.50
41753	35.00	71.50	80.50	19.00	15.50
41754	36.00	72.50	82.00	21.50	17.50
41755	40.00	82.00	93.00	24.20	20.50
41756	45.00	92.00	105.00	26.50	23.00
41757	45.50	99.00	114.00	28.00	23.50
41758	50.00	110.00	125.50	33.00	29.00

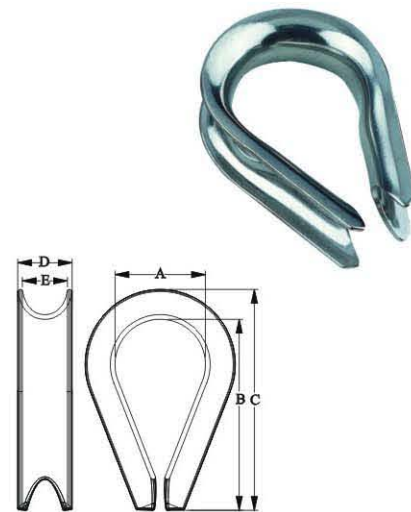

PAD EYE, STEEL ZINC PLATED.

Part No.	ϕ mm	A mm	B mm	C mm
41767	3.20	4.00	32.00	16.00
41768	4.20	5.00	40.00	17.50
41769	5.20	6.00	45.00	22.50
41770	5.20	8.00	50.00	23.00
41771	8.20	10.00	62.00	28.00

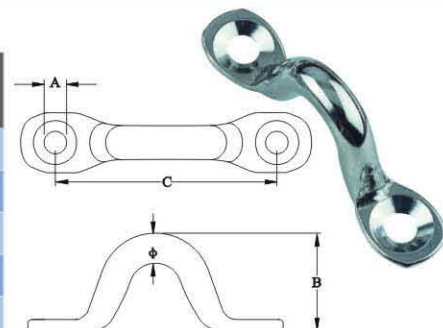

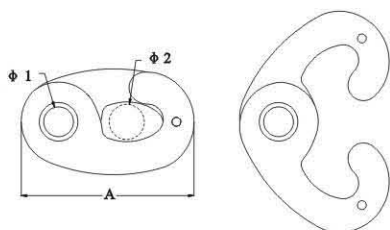
LAP LINK, STEEL ZINC PLATED.

Part No.	φ 1 mm	φ 2 mm	A mm
41774	13.50	18.00	78.50

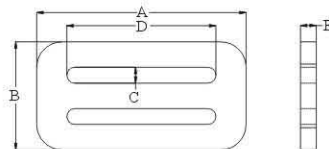
STEEL BUCKLE SLIDE, PE COATED.

Part No.	A mm	B mm	C mm	D mm	E mm
41773	66.00	34.00	5.00	47.00	5.00

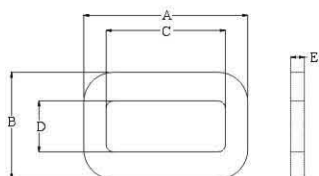
STEEL BUCKLE, PE COATED.

Part No.	A mm	B mm	C mm	D mm	E mm
41772	66.00	43.00	48.00	20.50	5.50

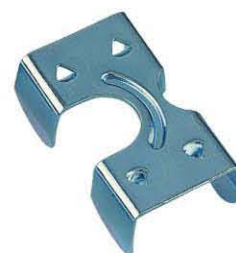
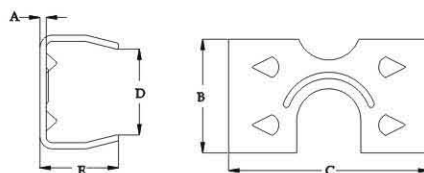
ROPE CLAMPS, STEEL ZINC PLATED.

Part No.	A mm	B mm	C mm	D mm	E mm
41775	0.80	23.00	39.00	18.50	17.50
41776	0.80	26.00	48.50	24.50	19.00
41777	1.00	40.00	51.50	31.00	28.50

HITCHING RING, STEEL ZINC PLATED.

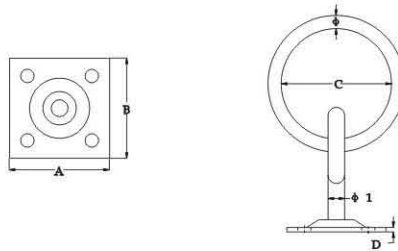

Part No.	$\phi 1$ mm	$\phi 2$ mm	A mm	B mm	C mm	D mm
41782	6.00	7.50	45.00	45.00	50.00	2.00

HITCHING RING, STEEL ZINC PLATED.

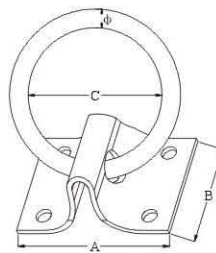

Part No.	ϕ mm	A mm	B mm	C mm
41783	7.00	61.50	44.00	50.00

CONCAVE HOOK, STEEL ZINC PLATED.

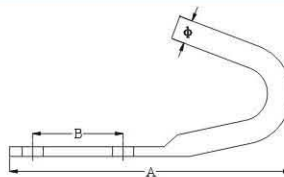

Part No.	ϕ mm	A mm	B mm
41781	8.00	95.00	30.00

EYE SCREW, STEEL ZINC PLATED.

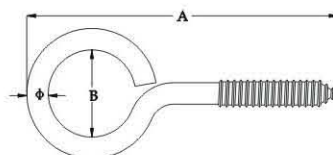

Part No.	ϕ mm	A mm	B mm
41778	6.28	74.50	19.00
41779	6.28	92.50	25.40
41780	5.00	96.00	16.00

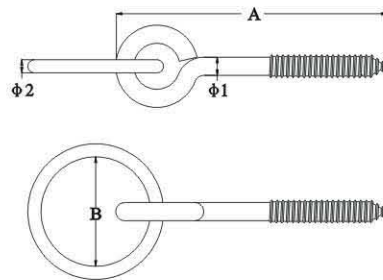
LAG EYE SCREW WITH RING, STEEL ZINC PLATED.

Part No.	$\phi 1$ mm	$\phi 2$ mm	A mm	B mm
41787	8.30	6.20	127.50	50.00

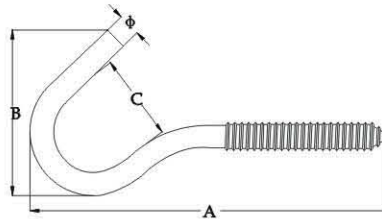
HOOK WITH SCREW, STEEL ZINC PLATED.

Part No.	ϕ mm	A mm	B mm	C mm
41786	6.28	103.00	46.00	25.00

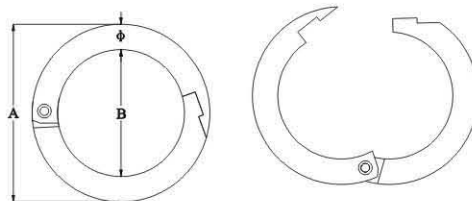
CHAIN CATCH, STEEL ZINC PLATED.

Part No.	ϕ mm	A mm	B mm
41784	6.00	42.00	30.00
41785	8.00	51.00	35.00

BUTT HINGE - STANDARD 'ALL STAINLESS'

COMPLETE WITH SCREWS - SOLD PER PAIR

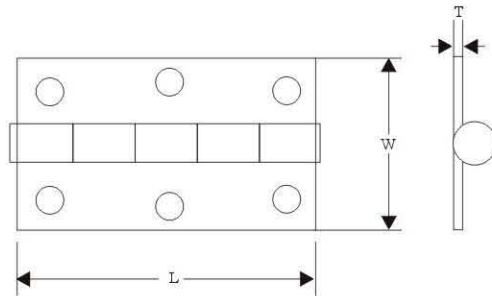

Part No. 304	Size mm	L mm	W mm	T mm	Screw Size
16412	2	50	38	1.5	6#
16413	2 1/2	63	40	1.5	6#
16414	3	76	48	1.5	6#
16377	4	101	70	1.8	8#

BUTT HINGE WITH NYLON BEARINGS

Part No. 304	Size mm	L mm	W mm	T mm	Screw Size
14710	2	50	38	1.5	6#
14709	2 1/2	63	40	1.5	6#
14711	3	76	48	1.5	6#
14841	4	101	70	1.8	8#

BUTT HINGE WITH NYLON BEARINGS - COMMERCIAL QUALITY

Part No. 304	Size mm	L mm	W mm	T mm	Screw Size
16461	4x3x2	101	76	2.0	8#
16321	4x4x2	101	101	2.0	8#

BUTT HINGE WITH STAINLESS BEARINGS - COMMERCIAL QUALITY

Part No. 304	Size mm	L mm	W mm	T mm	Screw Size
16322	4x4x2	101	101	2.0	8#
19248	4x4x3	101	101	3.0	8#
19249	5x4x3	127	101	3.0	8#

CUP HOOK - SHOULDERED

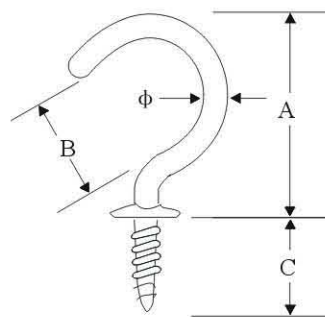

Part No. 304	Size mm	φ mm	A mm	B mm	C mm	Std Pack
31480	16	2.2	16	5	10	50
31481	20	2.4	20	7	12	50
31482	25	2.8	25	10	14	50
31483	28	3.2	28	10	15	50
31484	32	3.5	32	13	17	50

SCREW EYES

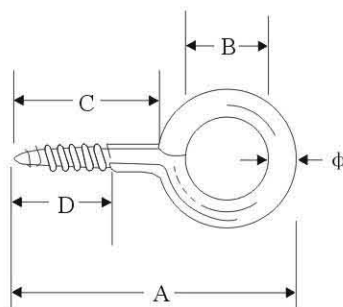

Part No. 304	Size mm	φ mm	A mm	B mm	C mm	D mm	Std Pack
31490	20	1.85	20.5	5	10	8	50
31491	23	2.15	23	6	12	10	50
31492	25	2.45	25	7	12	10	50
31493	29	2.8	29	9	13	11	50
31494	34	3.3	34	10	18	15	50
31495	42	3.9	42	12	20	15	50

PIANO HINGE

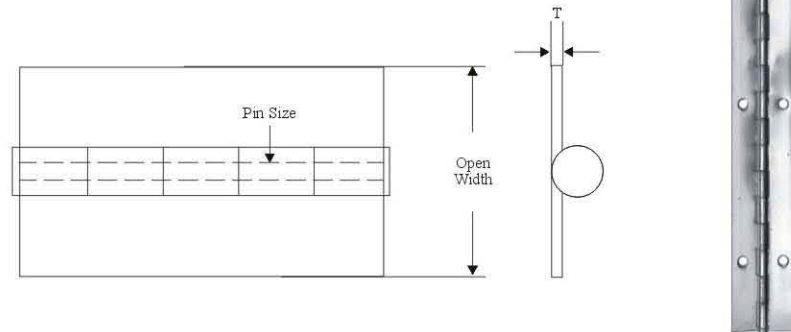

Part No. 304	Width Open mm	Width Closed mm	Length mm	Pin Diameter mm	Material Thickness mm
6930	M25(Undrilled)	16	1800	3.2	1.2
19031	M32(Undrilled)	19	1800	3.2	1.2
6931	M32(Drilled)	19	1800	3.2	1.2
14568	M38(Undrilled)	22	1800	3.2	1.2
14569	M50(Undrilled)	29	1800	3.2	1.2

U BOLTS COMPLETE WITH HEX NUTS AND FLAT WASHERS

WITH TWO NUTS AND FLAT WASHERS

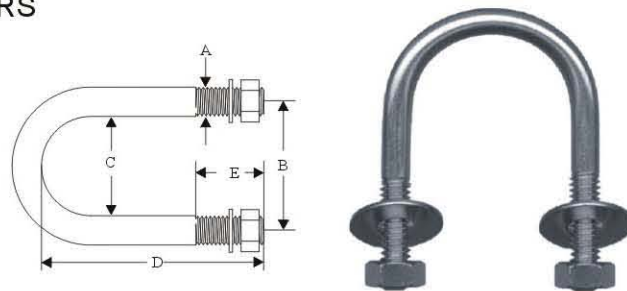

Part No. 316	Size (N.B)	Part No. 316	Size (O.D)	A	B mm	C mm	D mm	E mm
-	-	16289	3/4	1/4" unc	27	21	35.0	15
14435	1/2	-	7/8	1/4" unc	29	23	40.5	16
14314	3/4	-	1	1/4" unc	33	27	46.0	16
-	-	16292	1 1/4	1/4" unc	39	33	51.5	25
14315	1	-	1 3/8	1/4" unc	41	35	60.0	28
-	-	16294	1 1/2	1/4" unc	46	40	65.0	28
14316	1 1/4	-	1 11/16	1/4" unc	51	45	71.0	30
14317	1 1/2	-	2	1/4" unc	58	52	82.0	30
14318	2	-	2 3/8	1/4" unc	68	62	88.0	35
14436	2 1/2	-	3	5/16" unc	86	78	107	40
14437	3	-	3 3/8	5/16" unc	100	92	134	45
16523	4	-	-	3/8" unc	126	116	169	45
19129	6	-	-	1/2" unc	190	176	219	50

WIRE

SOLD ONLY IN ROLLS OF 305 METERS

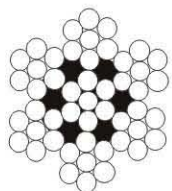

(7x7)

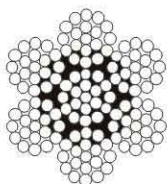

(7x19)

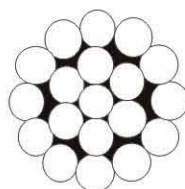

(1x19)

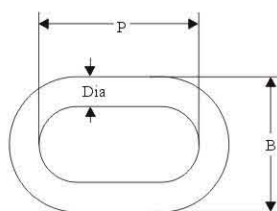

Part No. 316	Size mm	Breaking Strength (min) Kgs
38113	M3.2(1x19)	850
37479	M3.2(7x7)	580
31140	M3.2(7x19)	540

CHAIN (DIN 766)

Part No. 316	Size (D)	P mm	B mm	Wgt. KG/M	Breaking Strain
6920	M2*	22	8	0.16	150 Kg
16915	M3	16	11	0.16	800 Kg
6921	M4	16	14	0.32	1350 Kg
16916	M5	18.5	17	0.50	1970 Kg
6922	M6	18.5	20	0.75	2880 Kg
6923	M8	24	26	1.35	5100 Kg
6924	M10	28	34	2.25	7900 Kg

*M2 is DIN 763

GREASE NIPPLES STRAIGHT

Part No. 304	Size
5598	1/8 BSP
5600	1/4 BSP
5604	1/4 UNF
15843	M6
31256	M8



VIBRATORY FINISHING



WAX INJECTION



WAX SPRUE ASSEMBLING

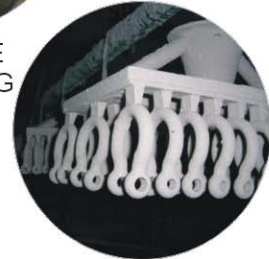

SHELL BUILDING



MINOR FINISHING OPERATION



DEWAX



GRINDING



CASTING



CUT OFF



KNOCKOUT

CHEMICAL COMPOSITION OF STAINLESS STEEL - AISI

STEEL GRADE		Chemical Composition (Weight %)								
GRADE NO	UNS NO	C	Mn	P	S	Si	Cr	Ni	Mo	Others
AISI 302	S30200	≤0.15	≤2.00	≤0.045	≤0.03	≤0.75	17.00~19.00	8.00~10.00	-	N≤0.10
AISI 302B	S30215	≤0.15	≤2.00	≤0.045	≤0.03	2.00~3.00	17.00~19.00	8.00~10.00	-	N≤0.10
AISI 303	S30300	≤0.15	≤2.00	≤0.200	≥0.15	≤1.00	17.00~19.00	8.00~10.00	-	-
AISI 303Se	S30323	≤0.15	≤2.00	≤0.200	≤0.06	≤1.00	17.00~19.00	8.00~10.00	-	Se≥0.15
AISI 304	S30400	≤0.08	≤2.00	≤0.045	≤0.03	≤0.75	18.00~20.00	8.00~10.50	-	N≤0.10
AISI 304L	S30403	≤0.03	≤2.00	≤0.045	≤0.03	≤0.75	18.00~20.00	8.00~12.00	-	N≤0.10
AISI 304N	S30451	≤0.08	≤2.00	≤0.045	≤0.03	≤0.75	18.00~20.00	8.00~10.50	-	N 0.10~0.16
AISI 304LN	S30453	≤0.03	≤2.00	≤0.045	≤0.03	≤0.75	18.00~20.00	8.00~12.00	-	N 0.10~0.16
AISI 316	S31600	≤0.08	≤2.00	≤0.045	≤0.03	≤0.75	16.00~18.00	10.00~14.00	2.00~3.00	-
AISI 316F	S31620	≤0.08	≤2.00	≤0.200	≤0.10	≤0.75	16.00~18.00	10.00~14.00	1.75~2.50	-
AISI 316L	S31603	≤0.03	≤2.00	≤0.045	≤0.03	≤0.75	16.00~18.00	10.00~14.00	2.00~3.00	-
AISI 316Ti	S31635	≤0.08	≤2.00	≤0.045	≤0.03	≤0.75	16.00~18.00	10.00~14.00	2.00~3.00	N≤0.10,Ti≥5*(C+N)~0.7
AISI 316N	S31651	≤0.08	≤2.00	≤0.045	≤0.03	≤0.75	16.00~18.00	10.00~14.00	2.00~3.00	N 0.10~0.16